

# Dorchester DR-LA Range

## Fully Automatic, Multi-tube Direct Gas Fired Water Heaters



There are 7 models in the DR-LA range with continuous outputs from 621 to 2105 litres/hour, based on a 44°C temperature rise. Storage capacities range from 264 to 374 litres. Two or more water heaters can be installed in a modular configuration where there is demand for larger loads.

The DR-LA is fitted with an atmospheric burner with fully automatic controls utilising hot surface ignition. The water heaters are suitable for firing natural gas or LPG, and have volt free contacts fitted as standard. The pre-wired control panel includes on/off switch, control thermostat, power indicator, lockout indicator and reset button.

### Options

- Natural gas or LPG
- Unvented supply kit
- Electrical anode protection
- Close temperature control kit
- Top to bottom recirculation kit
- Flexible magnesium sacrificial anodes
- Draught diverter with horizontal take off

Two large inspection doors provide access for servicing and maintenance, and the DR-LA range is designed to meet the latest HSC requirements for the control of Legionellosis. Connections are provided to facilitate top to bottom recirculation which ensures an even temperature is maintained throughout the vessel, preventing stratification.

A fully electronic soft start gas valve and hot surface ignition ensures reliable burner operation and minimal electro magnetic interference. The water heaters are suitable for open vented or unvented systems using an optional unvented supply kit, and are complete with a frost protection thermostat supplied as standard.

In plant rooms with insufficient headroom clearance for fixed anodes, flexible magnesium sacrificial anodes may be specified as an option.

All models are available with an optional draught diverter to provide a horizontal flue take-off. This must be specified at the time of ordering.

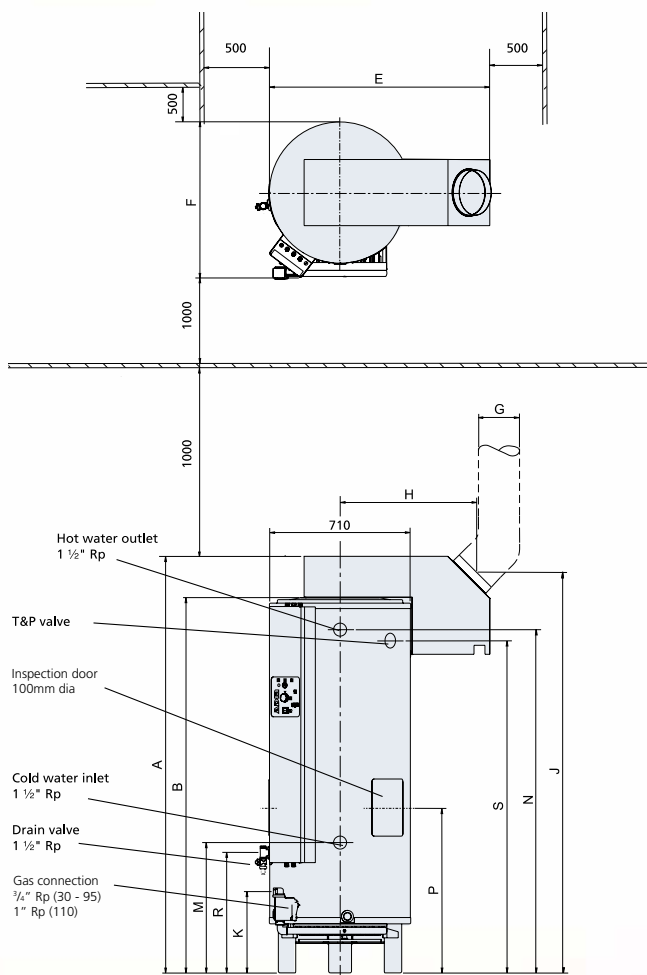

Model		DR-LA 30	DR-LA 40	DR-LA 45	DR-LA 60	DR-LA 75	DR-LA 95	DR-LA 110
Continuous output with 44°C Δt (80°F)	l/h	621	822	965	1199	1427	1838	2105
	UK gal/h	137	181	212	264	314	405	463
Storage capacity	litres	324	374	312	351	291	265	264
	UK gal	71	82	69	77	64	58	58
Time to recover storage 44°C Δt (80°F)	mins	32	28	20	16	13	9	7
Heater output	kW	31.7	42.0	49.3	61.2	72.9	93.9	107.5
Maximum water pressure (open vented)	bar	8						
	Psig	116						
Gas input rate natural gas (G20)	m <sup>3</sup> /h	4.0	5.4	6.3	7.8	9.4	12.1	13.7
	ft <sup>3</sup> /h	142.0	190.0	223.5	275.4	330.9	425.9	483.8
Propane input gas rate at 37m bar (14.85 l/wg) standard inlet pressure	m <sup>3</sup> /h	1.6	2.2	2.5	3.1	3.8	4.9	5.5
	ft <sup>3</sup> /h	57.2	76.6	90.1	110.9	133.4	171.6	195.0
Water flow and inlet connection	in	1 1/2" Rp						
Gas connections	in	3/4" Rp						1" Rp
Drain connection (hose connection) & Recirculation connection	in	1 1/2" Rp						
T&P Valve Connection	in	1"					1 1/2"	
Draught diverter spigot ID	mm	150	150	180	180	225	225	225
	in	6	6	7	7	9	9	9
Electrical supply		230V 50Hz 1Ph						

Dimensions in mm		DR-LA 30	DR-LA 40	DR-LA 45	DR-LA 60	DR-LA 75	DR-LA 95	DR-LA 110
Overall height	A	1900	2100	1900	2040	2000	2025	2085
Cylinder height	B	1760	1960	1760	1900	1795	1810	1870
Width including draught diverter	E	1100				1105		
Width including control column	F	800						
Flue spigot diameter	G	150		180		225		
Flue spigot centre line	H	640				675		
Flue spigot centre line	J	1840	2040	1840	1980	1935	1950	2010
Gas connection	K	400			340	400	340	205
Cold water inlet	M	565			505	575	590	650
Hot water outlet	N	1605	1810	1605	1750	1640	1655	1715
Inspection door	P	730			670	740	765	855
Drain	R	500	515	500	455	525	540	595
T & P Valve	S	1550	1760	1550	1700	1595	1600	1660

## Standard Features

- Fully automatic ignition
- Multi tube heat exchanger
- Control thermostat range 40°C to 70°C
- Magnesium sacrificial anodes
- Volt free contacts - for lockout and normal run
- Two inspection doors
- Combustion products discharge safety device
- Draught diverter with 45 degree take-off
- Frost protection thermostat